

HILL COUNTRY LAND SURVEYING CO
 110 NORTH MILAM, SUITE C
 FREDERICKSBURG, TEXAS 78624
 PHONE: (930) 990-2665

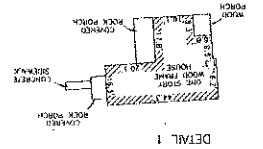

THIS MAP IS PREPARED FROM THE SURVEY DATA
 PROVIDED BY THE CLIENT AND THE SURVEYOR HAS
 CONDUCTED A VISUAL INSPECTION OF THE
 PROPERTY AND HAS FOUND THE DATA TO BE
 ACCURATE AND COMPLETE. THE SURVEYOR
 HAS NOT CONDUCTED A PHYSICAL SURVEY
 OF THE PROPERTY AND HAS NOT BEEN
 ADVISED OF ANY ENCUMBRANCES OR
 OTHER MATTERS AFFECTING THE
 PROPERTY. THE SURVEYOR'S LIABILITY
 IS LIMITED TO THE PREPARATION OF
 THIS MAP AND THE DATA PROVIDED BY
 THE CLIENT. THE SURVEYOR DOES NOT
 WARRANT THE ACCURACY OF THE DATA
 PROVIDED BY THE CLIENT OR THE
 RESULTS OF THIS SURVEY.

LEGEND
 ■ MAIL BOX
 ○ TELEPHONE FEEDSTAL
 ○ LIGHT POLE
 --- POWER POLE
 --- GUY WIRE
 --- WOOD FENCE
 --- ONE - OVERHEAD ELECTRIC

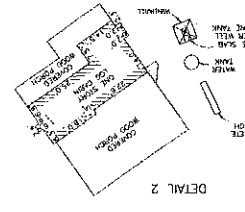

PETER LINNARTZ
 SURVEY NO. 629
 ABSTRACT NO. 365

LOT 3R

N 00°51'33" W
 149.39'
 (S 89°00'48" W 1850.00' CALLED)

S 88°56'54" W 319.66'
 (S 89°00'25" W 319.77' CALLED)

N 01°00'28" W 1492.19'
 (N 00°59'25" W 1481.73' CALLED)

HORTON PRIESS ROAD
 N 89°22'17" E 661.69' CALLED

JNO. HARGROVE
 SURVEY NO. 38
 ABSTRACT NO. 211

LAND TITLE SURVEY

N 89°00'48" E 1506.14'
 (N 89°00'35" E 1506.09' CALLED)

ADAMS, BEATTY AND MOULTON
 SURVEY NO. 809
 ABSTRACT NO. 2A

S 89°00'48" W 1849.88'
 (S 89°00'35" W 1850.00' CALLED)

LOT 7R

LOT 2R
 79.996 ACRES
 (80.000 ACRES CALLED)

S 00°58'41" E 1627.07'
 (S 00°59'25" E 1627.54' CALLED)

LOT 10R

LOT 9

